

Brazilian Amazon Adventure

April 25 – May 10, 2026

May 30 – Jun 14, 2026



Presented by

**GLP Worldwide for
University of Saskatchewan
Alumni and Friends**

*Travel for
Travellers*
BY GLP WORLDWIDE



**USASK
ALUMNI**

Dear Alumni and Friends,

Experience the incredible biodiversity of the Amazon rainforest like never before. We're excited to invite you on an exclusive adventure through the heart of this legendary wilderness, as we navigate the winding rivers of the Brazilian Amazon to explore its untouched and hardly visited depths.

Embark on a journey through the Amazon rainforest on board the MS Jangada, a boutique ship designed to navigate its winding rivers. While enjoying the comfortable and relaxing environment, take advantage of the diverse activities and excursions that provide opportunities to appreciate the natural wonders of the rainforest and engage with its unique Amazonian communities.

Starting from Manaus, a tropical metropolis in the heart of the Amazon rainforest, this exclusively chartered adventure takes you almost 1,000 miles (1,600 kilometers) into the undisturbed and rarely visited parts of the rainforest. Encounter a diverse range of wildlife, including caimans, howler monkeys, and piranhas, and explore the rainforest's unique and diverse plant life, which remains largely undiscovered and unnamed.

Throughout the journey, you'll be accompanied by expert guides who will enhance your understanding of the local wildlife, plants, and cultures. The guides will share their knowledge and stories, giving you a deeper appreciation of the Amazon's rich history and vibrant communities.

Space is limited to 22 passengers so please make your reservations early. For more information on our adventure and to reserve your spot, please contact GLP Worldwide at 1-866-760-1987 or alumni@glpworldwide.com.

Sincerely,



Dawn Warren
University of Saskatchewan Alumni Travel Program



Please contact GLP Worldwide at 1-866-760-1987 with questions regarding this tour. If you have questions regarding the University of Saskatchewan Alumni Travel Program or you no longer wish to receive Alumni Travel information, please contact the Alumni Relations office at 1-800-699-1907 or local 306-966-5186 or email alumni.office@usask.ca.

BRAZILIAN AMAZON ADVENTURE

April 25th – May 10th, 2026
May 30th - Jun 14th, 2026



The Amazon Theatre

BRAZILIAN AMAZON ADVENTURE ROUTE



DAY 1 | APR 25 | MAY 30 | DEPART CANADA
Depart for your flight to Manaus, Brazil.

DAY 2 | APR 26 | MAY 31 | ARRIVE MANAUS
Upon arrival, you will be transferred to the hotel.



Amazon rainforest

DAY 3 | APR 27 | JUN 1 | MANAUS – EMBARKATION - WELCOME TO THE AMAZON, TWO RIVERS – TWO COLOURS! (B, L, D)
Begin your adventure with a half day morning tour led by a knowledgeable guide, followed by lunch in the afternoon. Then, transfer to your site of embarkation and receive a warm welcome from the crew of the MS Jangada, your home for the next 13 days. As your ship departs, you'll witness the breathtaking natural phenomenon of the black waters of the Rio Negro and the white waters of the Amazon River flowing side by side without mixing for miles.

Overnight on board

DAY 4 | APR 28 | JUN 2 | ANAMÁ AND RIO PURUS (B, L, D)

In the morning, take a boat tour to explore the Anamá region's flora and fauna. After visiting a village, continue to the Rio Purus, where you'll see colorful macaws and fishermen catching giant catfish. On the way to Rio Badajos, observe the vibrant stilt villages, and with luck, spot pink river dolphins.

DAY 5 | APR 29 | JUN 3 | RIO BADAJOS (B, L, D)

In the early morning, take a boat trip to spot diverse bird species, including the rare horned screamer. You'll also see sloths, caimans, and the giant water rose, *Victoria Amazonica*, on the Rio Badajos. In the afternoon, another boat tour explores the rainforest's flora and fauna.



Maned Sloth

DAY 6 | APR 30 | JUN 4 | BRAZIL NUTS, CASSAVA AND THE SUPERFOOD AÇAÍ (B, L, D)

Overnight, the ship arrives at Via Lira. On a village walk, learn about açai berry harvesting, Brazil nut cultivation, and cassava processing. Afterward returning on board, attend a lecture on açai processing. In the afternoon, take an excursion boat to Tefé.



Uakari monkey



Amazon Rainforest

DAY 7 | MAY 1 | JUN 5 | FOLLOWING THE FOOTSTEPS OF MISSIONARIES (B, L, D)

Explore Tefé, one of the largest cities on your Amazon journey, founded by Portuguese missionaries in the 17th and 18th centuries. Marvel at the panoramic view of the ancient river from the monastery and uncover historical artifacts in the still-in-use buildings. Explore the town's market hall and enjoy free time for your own discoveries. In the afternoon, visit Mamirauá National Park, a UNESCO World Heritage Site, with excursion boats and on foot to explore its flooded rainforest and unique wildlife, including Uakari monkeys, sloths, cormorants, parrots, and toucans. At night, search for nocturnal animals and caimans with glowing eyes.



MS Jangada Tour Guide

DAY 8 | MAY 2 | JUN 6 | FOREST TOUR BY CANOE (B, L, D)

Today, explore the rainforest up close on a canoe trip with villagers, seeing birds, monkeys, and caimans. Around noon, depart Mamirauá National Park for Fonte Boa, enjoying the river's vibrant life with fishermen, children offer fruit and vegetables from small canoes. People in hammocks aboard colourful Amazon ships may even wave at you. This evening, exciting on-board lectures also provide amusement. Amazon river boats filled with hammocks pass by as you relax and listen to the insightful commentary of your expert tour guides.

DAY 9 | MAY 3 | JUN 7 | BUTTER ON THE FISH (B, L, D)

From Fonte Boa, take a boat trip to a tributary where locals catch the giant pirarucu fish, weighing up to 150 kg which is extremely tasty and is exported to all of Latin America. The ship then heads upstream, with another boat trip in the afternoon before continuing overnight to Jutai.



Ms Jangada Sun Deck

DAY 10 | MAY 4 | JUN 8 | AT THE END OF THE WORLD (B, L, D)

In the morning, take a boat trip to Jutai's tributaries and walk through the town to learn about the Caboclos. Relax on the sun deck as the ship sails through a remote Amazon region, passing jungle giants and spotting dorsal fins of grey and pink river dolphins. A lecture will introduce you to the Ticuna, the main indigenous people of Amazonas.

DAY 11 | MAY 5 | JUN 9 | VISITING A TICUNA VILLAGE (B, L, D)

Today, travel by motorboat to Bethania through scenic river tributaries. Experience the Ticuna's Moça Nova initiation dance in a ritual hut, with masks, black robes, feathers, and shells. After lunch by the lush Rio Iça, return to your ship and continue to Sao Paulo de Olivença.



Amazon River Dolphin

DAY 12 | MAY 6 | JUN 10 | AMAZON SUPER-FOOD (B, L, D)

In the morning, try piranha fishing and swim in the river. Explore the Rio Camatiã on a boat tour. In the afternoon, visit the Ticuna village of Villa Lira to learn about indigenous life. When the Amazon shimmers in red and purple at sunset, the ship begins the final leg of your journey.



Piranha Fishing



Fruits at a market in São Paulo

DAY 13 | MAY 7 | JUN 11 | VISITING THE JAGUAR MEN (BRAZIL, PERU) (B, L, D)

Today, reach city of Benjamin Constant, the last Brazilian outpost on the Peru border. Travel by land to visit the secluded Matis and Marubo natives. First, explore the Marubo village, then hike through the jungle to meet the Matis, who have only recently interacted with the outside world. Learn about their way of life, hunting, and rituals. In the afternoon, the ship arrives at Tabatinga, and you'll visit the Peruvian town of Santa Rosa across the river.



Ms Jangada Lounge Area



Matis Tribe

DAY 14 | MAY 8 | JUN 12 | IN THE TRI-BORDER AREA (BRAZIL, COLOMBIA) (B, L, D)

In the morning, enjoy breakfast on board, then explore the Colombian city of Leticia on foot. Visit the ethnological museum and experience the local flair. In the afternoon, pack and complete formalities for leaving Brazil.



Bogota Airport (BOG)



Black Howler



Deep into the rainforest

DAY 15 | MAY 9 | JUN 13 | RIO AMAZONAS – DISEMBARKATION – TABATINGA - LETICIA - BOGOTA (B)

Following breakfast, bid farewell to the exceptional ship and its gracious crew. Your journey into the uncharted territories of the Amazon has been an unparalleled adventure that will remain with you forever. You will be transported from the pier in Tabatinga to Leticia Airport for your flight to Bogota. Upon arrival, transfer to your hotel.

DAY 16 | MAY 10 | JUN 14 | DEPART BOGOTA (B)

Transfer to Bogota airport for your flight back to Canada.

*****END OF TOUR*****

B – breakfast L – lunch D – dinner

For navigational safety reasons, the cruise company and the captain are the only authorized persons who can modify the cruise itinerary.

SHIP INFORMATION

MS JANGADA

- Jangada, 2018
- Guest: 24
- Crew: 13
- Suites: 2
- Rooms: 10
- Length: 95 feet / 29 meters
- Width: 33 feet / 10 meters



Lounge Area



Dining Room



Sun Deck

DECKPLAN

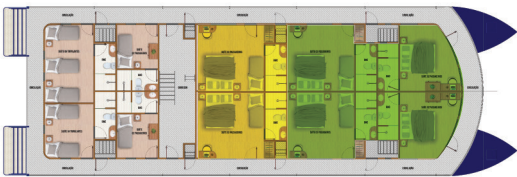

Main Deck

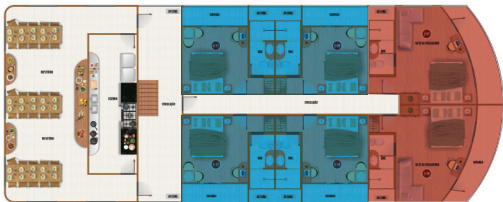

Upper Deck



Sun Deck

- Main Deck Classic
- Main Deck Superior
- Upper Deck Deluxe
- Upper Deck Suite



Main Deck Classic (approx. 17 m²)



Main Deck Superior (approx. 19 m²)



Upper Deck Deluxe (approx. 17 m²)



Upper Deck Suite (approx. 25 m²)

PRICING & TERMS

PACKAGE PRICE (CRUISE & LAND) PER PERSON:

CABIN CATEGORY	DOUBLE OCCUPANCY	SINGLE OCCUPANCY
Main Deck Classic	CAD 11,480 per person	CAD 16,830 per person
Main Deck Superior	CAD 12,490 per person	CAD 18,400 per person
Upper Deck Deluxe	CAD 13,500 per person	CAD 19,970 per person
Upper Deck Suite	CAD 14,510 per person	N/A

Single passengers booked in double occupancy cabins are limited to 10% of the total passengers travelling within the group

INCLUSIONS

- 1 pre-night at Manaus hotel including breakfast
- 13 days, 12 nights cruise on the exclusively chartered MS Jangada.
- 1 post-night at Bogota hotel including breakfast
- Meals included in the itinerary.
- Soft drinks on board.
- Excursions and transfers as per itinerary.
- Domestic flight from Leticia to Bogota including applicable air taxes and fees.
- Gratuities for local guides, ship crew, and driver for included excursions and portorage.

EXCLUSIONS

- International flights
- Meals not included in itinerary.
- Optional travel, health, accident or other insurances.
- Brazil E-visa cost at CAD 115 per person (price is subject to change)
- Colombian entry tax at CAD 85 per person (price is subject to change). **Colombian customs is located inside Leticia airport and Colombia Entry tax will be collected at airport.**
- **Yellow Fever Vaccination is mandatory required for entering Colombia**

ESTIMATED INTERNATIONAL AIR:

- Roundtrip airfare in economy class from Toronto to Manaus and return from Bogota to Toronto including applicable air taxes and fees at approximately CAD 2,120 per person
- Additional cost to be applied for other departure cities
- Please contact us for air deviation, premium economy or business class upgrade surcharges.

Note:

1. Passenger names must match passport.
2. Please ensure that passports are valid up till after six (6) months at last destination.

DEPOSIT AND PAYMENT

FIRST DEPOSIT	CAD 2,500 per each confirmed passenger at the time of booking
SECOND DEPOSIT	CAD 2,500 per each confirmed passenger due on Sep 30, 2025
FINAL PAYMENT	Due on Jan 15, 2026

CANCELLATION CHARGES

From time of booking to September 29, 2025	CAD 2,500 per person
From Sep 30, 2025 – Jan 14, 2026	CAD 5,000 per person
From Jan 15, 2026 – February 27, 2026	75% of tour cost
From Feb 28, 2026 – date of departure	100% of tour cost

Air cancellation penalties are subject to airline regulations.

We strongly recommend the purchase of trip cancellation or comprehensive travel insurance at the time of booking. Please contact GLP Worldwide for a quotation.

Any booking resulting out of the information in this brochure is subject to the complete terms & conditions found on our website www.travelfortravellers.com/alumni-travel/

GLP Worldwide acts solely as agent between the passenger and the supplier(s) providing services as described in the brochure. GLP Worldwide assumes no responsibility for any claims, damages or expenses arising from situations beyond our control. All trains, transportations and services booked are subject to the Conditions of Carriage of the relevant carrier. Full Conditions of Carriage for each carrier are available on our website or by contacting our office.



UNIVERSITY OF SASKATCHEWAN
UNIVERSITY RELATIONS
G15 Thorvaldson Building
110 Science Place
Saskatoon, SK S7N 5C9

UPCOMING INFO SESSION! CALL IN TODAY TO REGISTER NOW! 1-866-760-1987



**NORWAY
AND LAPLAND**
MAY 8 - 23, 2026



**HONG KONG
WINE AND DINE**
OCT 20 - 26, 2025



**SOUTH KOREA
AND JAPAN**
MAY 11 - 29, 2026



**ECUADOR
AND GALAPAGOS**
MAY 15 - 22, 2025



**GOLF CRUISE
ON DANUBE**
MAY 18 - 26, 2026



**THE BEST OF INDIA &
BRAHMAPUTRA RIVER**
OCT 3 - 19, 2025

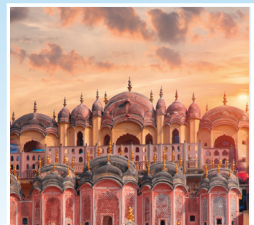

*Travel for
Travellers*

BY GLP WORLDWIDE

CONTACT GLP WORLDWIDE AT

26 - 1211 Denison Street, Markham, ON, Canada L3R 4B3
1-866-760-1987 | Monday - Friday | 9:00 AM - 6:00 PM
travelfortravellers.com
alumni@glpworldwide.com

TICO#: 50008899