

Golf Cruise on the Danube

MAY 16 – 26, 2026



Presented by

**GLP Worldwide for
University of Saskatchewan
Alumni and Friends**

*Travel for
Travellers*
BY GLP WORLDWIDE



**USASK
ALUMNI**

Dear Alumni and Friends:

Let the joy of vacation and the pleasure of golf play together.

Discover our unique Golf on the Danube cruise, where the world of luxurious river cruising meets the thrill of world-class golf. Embark on the ultimate golf cruise with our specially crafted itinerary, designed for both dedicated golfers and as well as holiday makers. Travel along the elegant Danube from Budapest to Passau, experiencing the perfect blend of relaxation and excitement. Enjoy a stress-free golf vacation, with exceptional service and tee times guaranteed at some of Europe's most spectacular golf courses. Our all-inclusive experience covers four beautifully situated courses, with transportation, green fees, shared golf carts, cultural excursions, sightseeing, and fine dining all part of the package.

Picture yourself relaxing on board our luxurious ship, soaking in the panoramic views of the Danube, and then stepping off to play on some of the finest courses in Europe. From historic cities to charming villages, our carefully curated itinerary ensures a perfect mix of breathtaking scenery, luxurious accommodations, and thrilling golf experiences. Whether you're a passionate golfer eager to tackle renowned courses or someone who prefers to immerse themselves in the river's serene landscapes, this cruise offers something for everyone. It's the ultimate escape, where adventure, relaxation, and luxury combine to create a truly unforgettable experience.

Spaces for this exclusive golf cruise are limited, so don't miss out on the chance to experience the beauty of the Danube and the thrill of playing on some of Europe's finest greens. For more information on our adventure and to reserve your spot, please contact GLP Worldwide at 1-866-760-1987 or alumni@glpworldwide.com.

Sincerely,



Dawn Warren
University of Saskatchewan Alumni Travel Program



Please contact GLP Worldwide at 1-866-760-1987 with questions regarding this tour. If you have questions regarding the University of Saskatchewan Alumni Travel Program or you no longer wish to receive Alumni Travel information, please contact the Alumni Relations office at 1-800-699-1907 or local 306-966-5186 or email alumni.office@usask.ca.

ITINERARY

GOLF CRUISE ON THE DANUBE

May 16th - 26th, 2026



Hungarian Parliament Building, Budapest



DAY 1 | MAY 16 | DEPART CANADA

Board your overnight flight to Budapest, Hungary.

DAY 2 | MAY 17 | ARRIVE BUDAPEST (D)

Upon arrival, you will be transferred to your hotel. Dinner at hotel.

Accommodation: Budapest Hilton Hotel or similar
(2 nights)



Matthias Church, Budapest

DAY 3 | MAY 18 | BUDAPEST (B)

This morning, enjoy a half day walking tour with an English speaking guide. Starting from the hotel, walk through the revitalized City Park, home to one of Europe's largest cultural development projects. During the tour, you will discover award-winning architectural gems such as the House of Hungarian Music. Highlights also include Heroes' Square, an exterior view of the Ethnographic Museum, the picturesque Vajdahunyad Castle, and the iconic Széchenyi Thermal Bath.

Included meals: B – breakfast, L – lunch, D – dinner

DAY 4 | MAY 19 | BUDAPEST - EMBARKATION
(B, D)

Today, you will be transferred to pier to embark your ship.

This evening, join us for a Welcome Cocktail, followed by a specially-prepared Welcome Dinner with a spirited folklore show of local artists who dance, sing and enchant aboard.

Accommodation: Amadeus Amara or similar (7 nights)

DAY 5 | MAY 20 | BUDAPEST - ESZTERGOM
(B, L, D)

Included excursions for Golf passengers:

Discover the beautiful sights and attractions of the Hungarian capital. This morning, you will be transferred to the Pannónia Golf and Country Club, picturesquely situated in a valley bordering the Etyek wine region. In the afternoon, rejoin the ship in Esztergom just before dinner.

Included excursions for Non-Golf passengers:

Budapest - Castle Hill & Historic Wonders
Discover stunning Baroque architecture, including the Hungarian State Opera and the iconic Parliament building, completed in 1904. Stop for photos at Heroes' Square, featuring monuments to Hungarian kings. Cross one of the seven bridges into Buda, visit St. Matthew's Church and Fisherman's Bastion (if open), and take in the breathtaking city views before returning to the vessel.



Pannónia Golf and Country Club

Esztergom, Visegrád castle and Szentendre
The tour starts in Budapest and takes you to Szentendre, an artists' village known for its museums and galleries, including the Margit Kovács Museum. Explore the main square, Foetér, with its cafes and shops. Next, visit the ruins of Visegrád Fortress for stunning views of the Danube Bend, followed by Esztergom, the former royal seat.



Esztergom, Hungary

DAY 6 | MAY 21 | BRATISLAVA (B, L, D)

Included excursions for Golf passengers:

After breakfast you are transferred to the Penati Golf Club, which is situated near the town of Senica and features the longest hole in Europe. In the evening, enjoy dinner on board before the vessel departs Slovakia and crosses into Austria.



Penati Golf Club

Included excursions for Non-Golf passengers:

Explore the capital of Slovakia with a driving tour past St. Martin's Cathedral, Grassalkovich Palace, and up to Castle Hill for panoramic city views. Then, enjoy a guided walking tour through the old town, visiting Michael's Gate, Primatial Palace, St. Martin's Cathedral, Academia Istropolitana, and the main square with the City Hall, Opera House, and Maximilian Fountain. Stop for a treat at a cozy spot to try Pressburger rolls. The tour ends at the Opera House and Ganymede's Fountain, with free time to explore or return to the ship.

In the evening, a particularly elegant experience awaits: A waltz dance class on board, where you'll glide across the floor to the rhythm of the music and immerse yourself in the traditional Viennese dance experience.



Michael's Gate Tower, Bratislava

DAY 7 | MAY 22 | VIENNA (B, L, D)

Included excursions for Golf passengers:

The magnificent capital city of Austria features many world-famous sights such as St. Stephen's Cathedral, the Vienna State Opera and Schönbrunn Palace, among many others. In the morning, you are transferred to the Fontana Golf Club, picturesquely situated about 30 kilometers south of Vienna, with a view of the Schneeberg, the highest mountain in Lower Austria, and the foothills of the Viennese Forest.



Fontana Golf Club

Included excursions for Non-Golf passengers:

Vienna - Imperial discovery tour
This tour offers a glimpse of Vienna's top sights. Drive along the Ringstrasse, passing landmarks like the opera house, parliament, Court Theatre, and city hall. Then, take a guided walk through the city center, starting at the Hofburg Imperial Palace, strolling along Kohlmarkt, and ending at St. Stephen's Cathedral. Enjoy free time to explore the pedestrian area before returning to the ship. In the evening, enjoy Sound of Vienna" classical concert.



Sound of Vienna Classical Concert



Dürnstein village in the Wachau Valley

DAY 8 | MAY 23 | VIENNA - DUERNSTEIN - MELK - EMMERSDORF (B, L, D)

Included excursions for Golf passengers & Non-Golf passengers:

Dürnstein with Abbey and tasting
Discover Dürnstein, a hidden gem in the Wachau Valley, known for its stunning scenery, traditional architecture, and apricot-based delicacies. Stroll past the town hall and castle ruins, tasting local treats like apricot juice, brandy, or liquor. Visit the 700-year-old Schloss Dürnstein for panoramic views of the Danube and cliffs. Explore the famous Abbey and enjoy a glass of wine to toast the end of your visit.

Golf passengers:

Alternatively, join the optional full-day trip to Lengenfeld Golf Club (at an approximately price EURO 164 per person)

Included excursions for Non-Golf passengers:

Melk Abbey is an Austrian Benedictine abbey and one of the world's most famous monastic sites. A guided tour takes you through the abbot's chambers, along the emperor's walk, through the marble hall, the balconies and the library.



Melk Abbey

DAY 9 | MAY 24 | LINZ (B, L, D)

Included excursions for Golf passengers:

Early in the morning, your ship reaches the erstwhile cultural capital, Linz, where your vessel makes a short stop for the departure of today's golf excursion - a full day tour to the legendary Quellness Golf Resort / Beckenbauer Golf Course. This evening the captain invites you to a festive Gala Dinner, full of wonderful regional dishes.



Legendary Quellness Golf Resort

Included excursions for Non-Golf passengers:

Visit the Ars Electronica Center and dive into a world of innovation – from interactive installations to visionary technologies.

AMADEUS Active: Hiking in Linz
Discover the Northern side of the Danube – Pöstlingberg, the favorite peak of Linz



Linz

DAY 10 | MAY 25 PASSAU (B, L, D)

Golf passengers:

Free day at leisure with various optional tours
Alternatively, join the optional full-day trip to the Regensburg Golf Club (at an approximately price EURO 175 per person)

Included excursions for Non-Golf passengers:

In the morning, join a special AMADEUS TASTE:
Culinary tour Passau

This evening, you'll enjoy a hearty Bavarian evening with live music and regional delicacies



Passau

DAY 11 | MAY 26 DISEMBARKATION - PASSAU – MUNICH – DEPARTURE (B)

In the early morning, we reach our final destination – Passau. After breakfast, transfer you to the Munich airport for your flight home.

*****END OF TOUR*****

B – breakfast L – lunch D – dinner

For navigational safety reasons, the cruise company and the captain are the only authorized persons who can modify the cruise itinerary.

SHIP INFORMATION

AMADEUS AMARA

- Amara, 2025
- Guest: 164
- Crew: approx. 46
- Cabin/Suites: 70/12
- Length: 443 feet / 135 meters
- Width: 37.4 feet / 11.4 meters

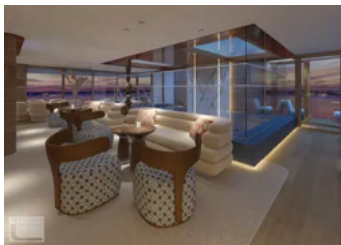

Indoor Pool



Cabin Room



Amadeus Suite

DECKPLAN

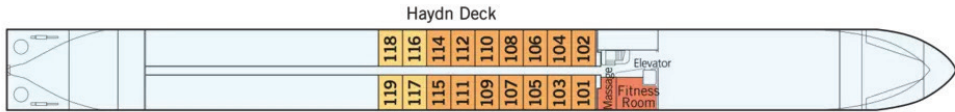
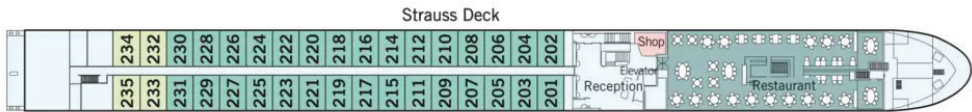
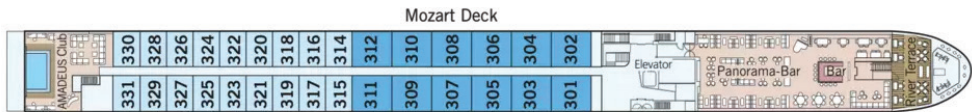
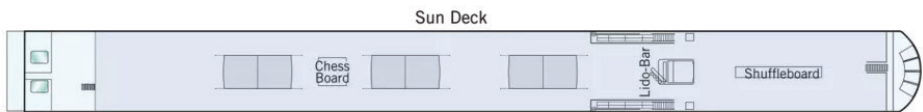
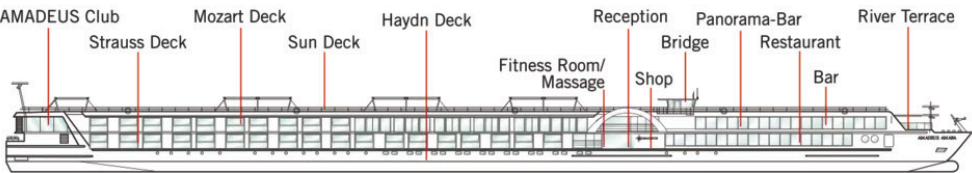

- AMADEUS Suite
- Cabin A-1
- Cabin B-1
- Cabin B-4
- Cabin C-1
- Cabin C-4

PRICING & TERMS

GOLF CRUISE PACKAGE RATE (CRUISE & LAND) PER PERSON:

CABIN CATEGORY	DECK	DOUBLE OCCUPANCY	SINGLE OCCUPANCY
Category C-4	Haydn Deck	CAD 6,980 per person	CAD 7,980 per person
Category C-1	Haydn Deck	CAD 7,480 per person	CAD 8,480 per person
Category B-4	Strauss Deck	CAD 7,980 per person	CAD 9,580 per person
Category B-1	Strauss Deck	CAD 8,280 per person	CAD 10,680 per person
Category A-1	Mozart Deck	CAD 8,680 per person	CAD 11,680 per person
Category Suite	Mozart Deck	CAD 9,480 per person	CAD 14,580 per person

NON-GOLF CRUISE PACKAGE RATE (CRUISE & LAND) PER PERSON:

CABIN CATEGORY	DECK	DOUBLE OCCUPANCY	SINGLE OCCUPANCY
Category C -4	Haydn Deck	CAD 5,680 per person	CAD 6,680 per person
Category C-1	Haydn Deck	CAD 6,180 per person	CAD 7,180 per person
Category B-4	Strauss Deck	CAD 6,680 per person	CAD 8,280 per person
Category B-1	Strauss Deck	CAD 6,980 per person	CAD 9,380 per person
Category A-1	Mozart Deck	CAD 7,380 per person	CAD 10,380 per person
Category Suite	Mozart Deck	CAD 8,180 per person	CAD 13,280 per person

INCLUSIONS

- 7 nights accommodation onboard MS Amadeus Amara or similar
- Cruise Inclusions Onboard:
 - Golf Program (apply to Golf passengers)
 - 4 rounds of golf at top golf courses
 - Green fees, reserved & pre-paid tee times, driving range balls
 - Shared electric golf carts (subject to availability) Lunch box (on request)
 - Ship crew assistance with golf bags from/to cabin (on request)
 - Transfer from ship to golf club and return to ship
 - Services of an experienced golf expert and tour leader
 - Select excursions as outlined in the itinerary (included)
 - Suites & Staterooms
 - Luxury accommodation in an outside river-view stateroom of your choice: Spacious Mozart Suites with a walk-out balcony, stateroom cabins on Mozart and Strauss Decks with drop-down Panorama Retractable
 - Windows offering a wide-open view
 - Individual climate control and in-room safe
 - Choice of bed configuration in all categories (double or twin bedding)
 - Gourmet Dining
 - Gourmet dining featuring breakfast, multi-course lunches and dinners with menu choices (including vegetarian options), afternoon tea and late-night snack
 - Free-flowing hand-selected wines from the best wine regions of Europe served with dinner on board
 - Coffee and tea available 24 hours a day in the Amadeus Club
 - Welcome and Farewell Cocktail Reception, Welcome Dinner and Captain's Gala Dinner
 - Voyage of Discovery
 - Personalized service of an experienced, multilingual AMADEUS Cruise Director
 - AMADEUS digital audio system for all guided excursions
 - Variety of enriching onboard programs, including fascinating lectures, cooking demonstrations, local cultural performances, and music by our onboard musicians
 - Complimentary use of onboard bicycles for independent exploration
 - Onboard fitness center open 24 hours a day
 - All port taxes, embarkation, disembarkation and lock fees
- Specially included for our group:
 - Beverage package with both lunch and dinner in the main restaurant: a choice of mineral water, soft drinks, juices, regional quality wine, and draft beer
 - Bottled water in the cabin
 - WIFI onboard
- Roundtrip airport transfers
- All port taxes and local taxes
- Pre-cruise land as per itinerary
- 2 nights hotel accommodation in Budapest with daily breakfast
- 1 dinner at hotel in Budapest
- Tours and transfers as per itinerary

PRICING & TERMS

EXCLUSIONS

- International flights
- Meals not included in the itinerary
- Optional cruise shore excursions and golf course not mentioned as included
- Optional travel insurance

ESTIMATED INTERNATIONAL AIR:

- Roundtrip airfare in economy class Toronto to Budapest and return from Munich to Toronto including applicable air taxes and fees at approximately CAD 1,700 per person
- Additional cost to be applied for other departure cities
- Please contact us for air deviation, premium economy or business class upgrade surcharges

Note:

1. *Passenger names must match passport.*
2. *Please ensure that passports are valid up till after six (6) months at last destination.*

DEPOSIT AND PAYMENT

FIRST DEPOSIT	CAD 1,000 per each confirmed passenger at the time of booking
SECOND DEPOSIT	CAD 2,000 per each confirmed passenger due on Oct 31, 2025
FINAL PAYMENT	Due on Jan 15, 2026

CANCELLATION CHARGES

From time of booking to Oct 30, 2025	CAD 1,000 per person
From Oct 31, 2025 – Jan 14, 2026	CAD 3,000 per person
From Jan 15, 2026 – Feb 14, 2026	75% of tour cost
From Feb 15, 2026 – date of departure	100% of tour cost

Air cancellation penalties are subject to airline regulations.

We strongly recommend the purchase of trip cancellation or comprehensive travel insurance at the time of booking. Please contact GLP Worldwide for a quotation. Prices above are in Canadian Dollars. The program and all related travel services described herein are subject to the detailed terms & conditions of GLP Worldwide which are available at any time upon request and which will be provided with your booking confirmation.

Any booking resulting out of the information in this brochure is subject to the complete terms & conditions found on our website www.travelfortravellers.com/alumni-travel/

GLP Worldwide acts solely as agent between the passenger and the supplier(s) providing services as described in the brochure. GLP Worldwide assumes no responsibility for any claims, damages or expenses arising from situations beyond our control. All trains, transportations and services booked are subject to the Conditions of Carriage of the relevant carrier. Full Conditions of Carriage for each carrier are available on our website or by contacting our office.

OPTIONAL EXTENSION TOUR TO BAVARIA

DAY 11 | MAY 26 | DISEMBARKATION - PASSAU - WALHALLA - REGENSBURG (B, L)

Start your Bavarian tour with a drive to Regensburg, stopping at the Walhalla monument, a Neoclassical Greek-style building above the Danube, known as the "German Pantheon." Afterward, continue to Regensburg for a 3-course lunch, followed by a walking tour of the UNESCO-listed medieval city. Highlights include the 12th-century Stone Bridge and the Gothic cathedral with twin towers. In the afternoon, check into your hotel.



Walhalla

DAY 12 | MAY 27 | BAVARIA EXPLORER AROUND REGENSBURG (B, L)

Spend the day exploring the Regensburg region, starting with a visit to Weltenburg Monastery, the oldest monastic settlement in Bavaria, founded around 600. The abbey church, a Baroque masterpiece, was built between 1716 and 1739. Enjoy a 3-course lunch at the world's oldest inn, family-run since 1658. Afterward, return to Regensburg for a free afternoon.

DAY 13 | MAY 28 | FROM THE DANUBE VIA MUNICH TO THE ALPS (B, D)

After breakfast, depart Regensburg for a sightseeing tour of Munich. Explore Marienplatz Square, home to the city hall, fountains, and carillon, and visit the Olympic Park, English Garden, and Nymphenburg Palace. Enjoy free time for lunch, then head to the Chiemgau region and check into your hotel in the alpine village of Inzell for a three-night stay. This picturesque area, shaped by glaciers, features rugged rocks, forests, mountain lakes, and diverse wildlife. Dinner at the hotel.



Weltenburg Monastery

DAY 14 | MAY 29 | LAKE CHIEMSEE (B, D)

Lake Chiemsee, often called the "Bavarian Sea," covers 80 square kilometers and is set against the stunning Alpine backdrop. We'll explore the lake by boat, visiting two islands: Herren-Chiemsee, home to King Ludwig's impressive Versailles-inspired castle, and Frauen-Chiemsee, a peaceful retreat offering a break from everyday life. Frauen-Chiemsee is also a pilgrimage site, featuring a Benedictine monastery and shop, where visitors experience the island's serene, welcoming atmosphere. Dinner at hotel.



Hohen-Salzburg Fortress

DAY 15 | MAY 30 | SALZBURG (B, D)

Salzburg, meaning "Salt-Fortress," became wealthy from its salt, or "white gold." In the morning, visit the world's oldest visitor mine in Hallein to learn the story of salt through modern technology. Then, explore Salzburg's old town, birthplace of Mozart. Visit the Hohen-Salzburg Fortress, the largest fully preserved castle in Central Europe, offering panoramic views of the city. We'll take the funicular to easily reach the top and return. Dinner at hotel.

DAY 16 | MAY 31 | DEPART MUNICH (B)

After breakfast, transfer to Munich and prepare for your return flight home.

*** END OF TOUR ***

B – Breakfast L – Lunch D – Dinner

PRICING & TERMS

PACKAGE RATE (CAD\$, per person) (Based on a minimum of 10 passengers):

DOUBLE/TWIN OCCUPANCY	SINGLE OCCUPANCY
CAD 4,850 per person	CAD 5,310 per person

INCLUSIONS

- 2 nights hotel in Regensburg including daily breakfast
- 3 nights hotel in Bad Reichenhall including daily breakfast
- 1 lunch at local restaurant
- 1 lunch at the world's oldest inn
- 3 dinners at Hotel
- Meals included in the itinerary
- Tours and transfers as per itinerary

EXCLUSIONS

- International flights
- Meals not included in itinerary
- Optional travel, health, accident or other insurances

DEPOSIT AND PAYMENT

FIRST DEPOSIT	CAD 1,000 per each confirmed passenger at the time of booking for post
FINAL PAYMENT	Due on Jan 15, 2026

CANCELLATION CHARGES

From time of booking to Jan 14, 2026	CAD 1,000 per person
From Jan 15, 2026 – Feb 14, 2026	50% of tour cost
From Feb 15, 2026 – date of departure	100% of tour cost

Air cancellation penalties are subject to airline regulations.

We strongly recommend the purchase of trip cancellation or comprehensive travel insurance at the time of booking. Please contact GLP Worldwide for a quotation. Prices above are in Canadian Dollars. The program and all related travel services described herein are subject to the detailed terms & conditions of GLP Worldwide which are available at any time upon request and which will be provided with your booking confirmation.

Any booking resulting out of the information in this brochure is subject to the complete terms & conditions found on our website www.travelforthravellers.com/alumni-travel/

GLP Worldwide acts solely as agent between the passenger and the supplier(s) providing services as described in the brochure. GLP Worldwide assumes no responsibility for any claims, damages or expenses arising from situations beyond our control. All trains, transportations and services booked are subject to the Conditions of Carriage of the relevant carrier. Full Conditions of Carriage for each carrier are available on our website or by contacting our office.



UNIVERSITY OF SASKATCHEWAN
UNIVERSITY RELATIONS
G15 Thorvaldson Building
110 Science Place
Saskatoon, SK S7N 5C9

UPCOMING INFO SESSION! CALL IN TODAY TO REGISTER NOW! 1-866-760-1987



**NORWAY
AND LAPLAND**
MAY 8 - 23, 2026



**HONG KONG
WINE AND DINE**
OCT 20 - 26, 2025



**SOUTH KOREA
AND JAPAN**
MAY 11 - 29, 2026



**ECUADOR
AND GALAPAGOS**
MAY 15 - 22, 2025



**BRAZILIAN AMAZON
ADVENTURE**
APR 25 - MAY 10 2026
MAY 30 - JUN 14 2026



**THE BEST OF INDIA &
BRAHMAPUTRA RIVER**
OCT 3 - 19, 2025

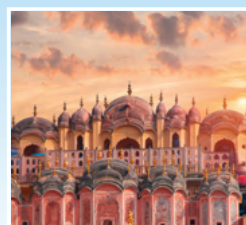

*Travel for
Travellers*
BY GLP WORLDWIDE

CONTACT GLP WORLDWIDE AT

26 - 1211 Denison Street, Markham, ON, Canada L3R 4B3
1-866-760-1987 | Monday - Friday | 9:00 AM - 6:00 PM
travelfortravellers.com
alumni@glpworldwide.com